

EAVE AT FLUSH WALL OR FASCIA / ZERO OVERHANG

MC-10B

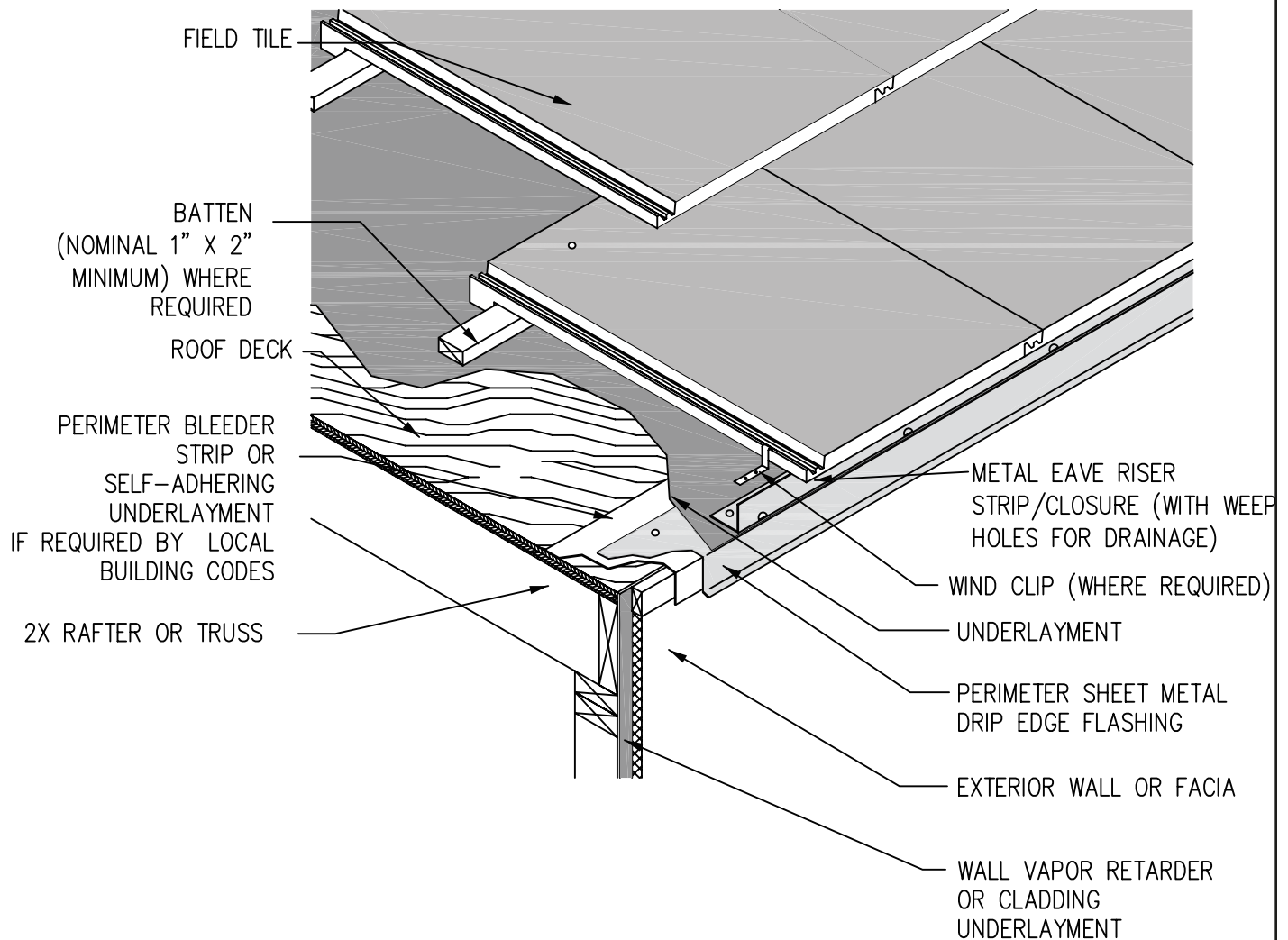

Notes:

1. One layer of No. 30 asphalt-saturated felt complying with ASTM D-226 Type II (ASTM D4869 Type IV) is required as minimum underlayment on all tile roof applications. Other underlayments may be used as approved by local building officials.
2. A sheet metal drip edge flashing is required with: stucco fascia, EIFS (Exterior Insulated Finish System) and flush fascia perimeter edges.
3. The fasteners must penetrate a minimum of 3/4" into dimensional wood decking or pass through wood panel sheathing which ever is less.
4. Battens for tiles with protruding anchor lugs are optional for slopes between 3:12 and 7:12. Direct deck nailing attachment of tile may be permissible.
5. For recommended tile fastening schedule(s) see Fastening Table 1A and 1B.
6. Eave closure should be of height equal to combined thickness of batten system and thickness of one course of tile.
7. Dimensions shown are minimums and are intended to be approximate to allow for reasonable tolerances due to field conditions.

DRAWING SHOWN DEPICTS THE APPLICATION OF ALL TILE PROFILES. UNLESS OTHERWISE NOTED IT WOULD APPLY TO EITHER CONCRETE OR CLAY TILES.

Copyright© Tile Roofing Institute/WSRCA
 ICC-ES ESR-2015 01/2002, revised 04/2006

USA Owned. USA Made.
www.eagleroofing.com

