

# RAKE TILE INSTALLATION

MC-19B

FOR ADDITIONAL FASTENING IN REGIONS SUBJECT TO EXCESSIVELY HIGH WINDS OR SNOW ACCUMULATION, A MINIMUM 1" DAB OF CODE APPROVED ADHESIVE IS RECOMMENDED AT OVERLAP

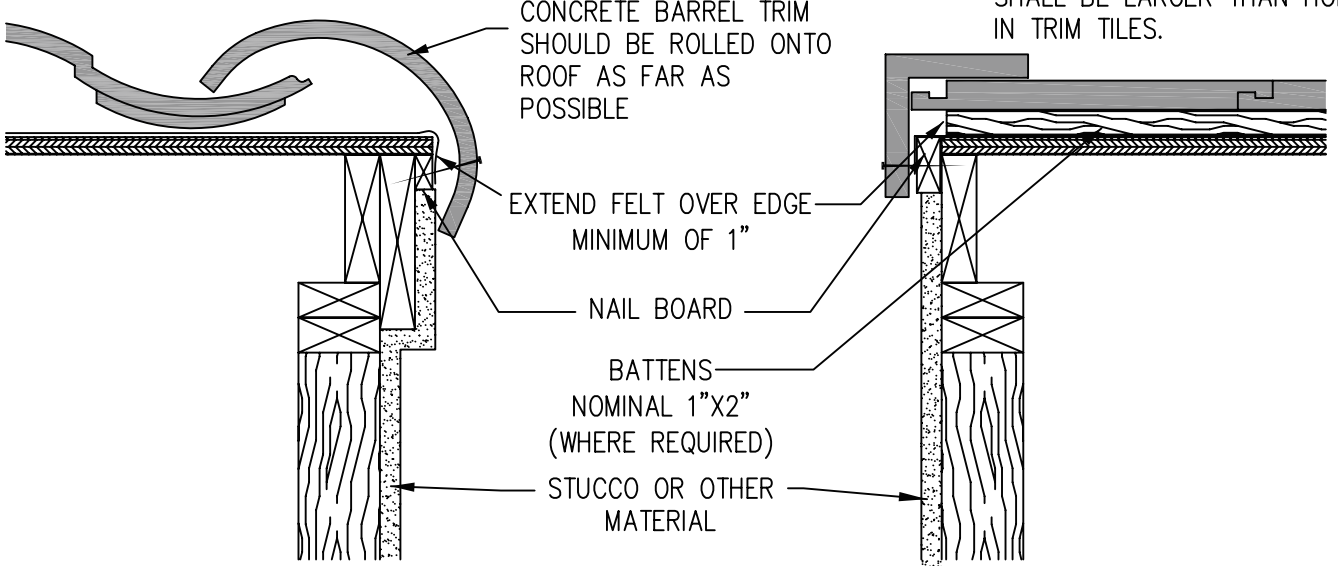
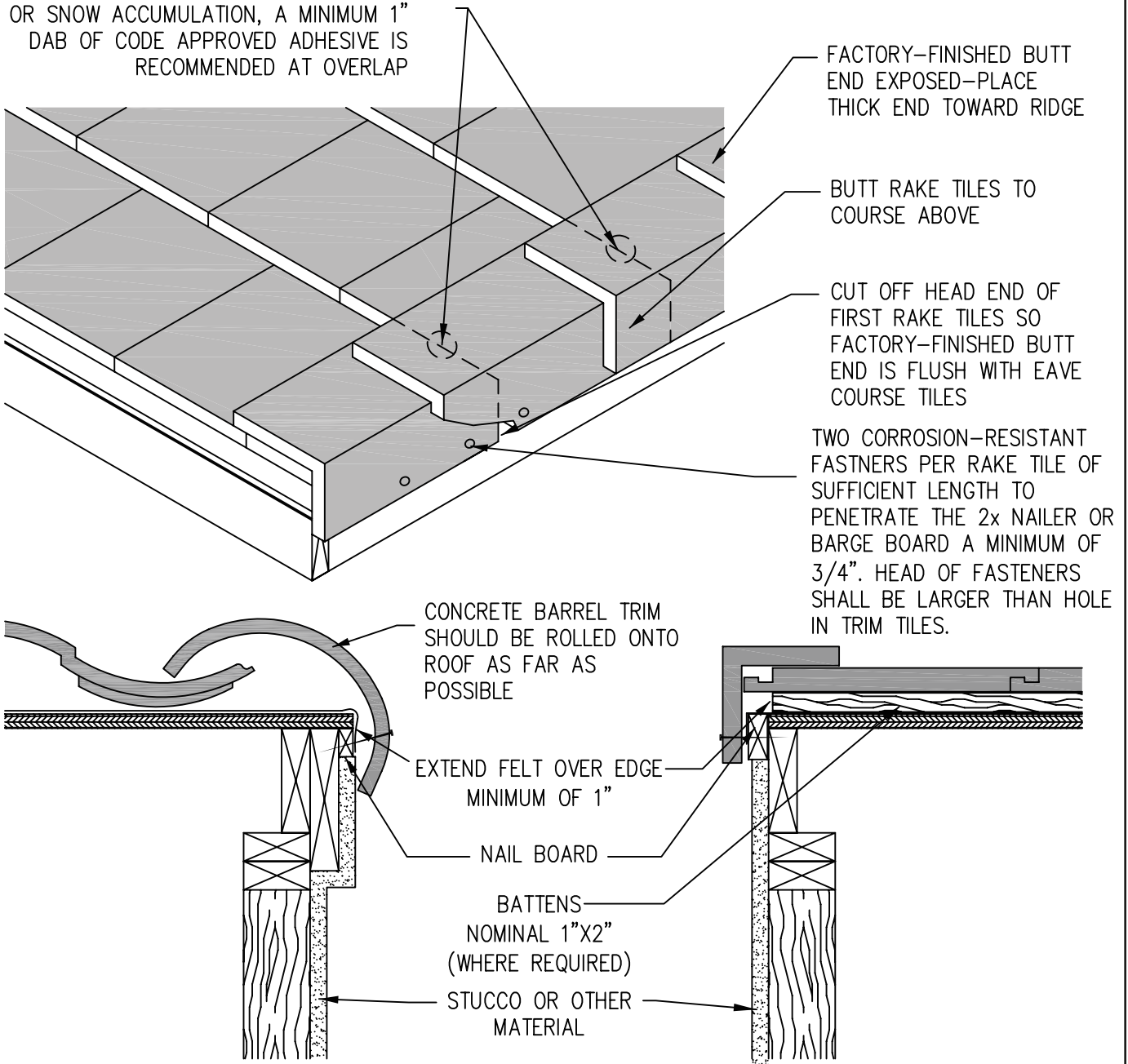

**Notes:**

1. Dimensions shown are minimums and are intended to be approximate to allow for reasonable tolerances due to field conditions.
2. See Footnote 4 Table 1A for additional fastening instructions.
3. Rake tiles must be fastened into a minimum nominal 2" gable fascia or equivalent in dimension.
4. The fasteners must penetrate a minimum of 3/4" into dimensional wood lumber.

DRAWING SHOWN DEPICTS THE APPLICATION OF ALL TILE PROFILES. UNLESS OTHERWISE NOTED IT WOULD APPLY TO EITHER CONCRETE OR CLAY TILES.

Copyright© Tile Roofing Institute/WSRCA  
ICC-ES ESR-2015 01/2002, revised 04/2006

USA Owned. USA Made.  
www.eagleroofing.com

