

Core Components

And Ventilated Roof System Guide For Concrete Tile Roofing

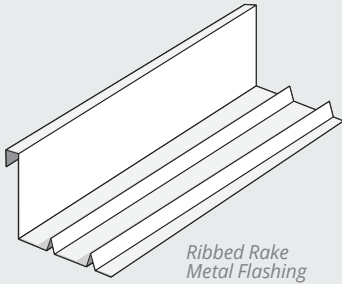

Ribbed Rake
Metal Flashing

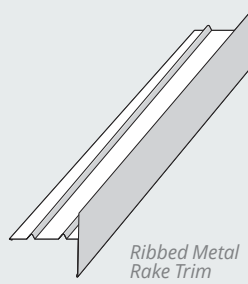

Ribbed Metal
Rake Trim

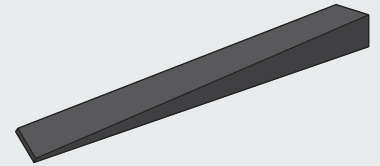

Rake Seal

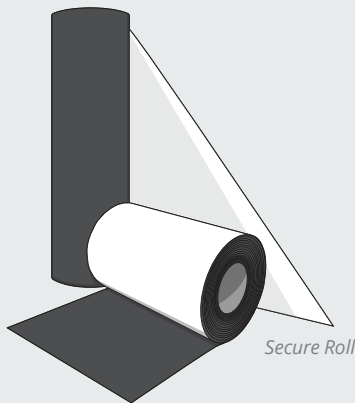

Secure Roll

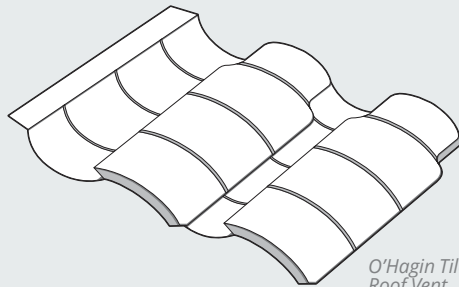

O'Hagin Tile
Roof Vent

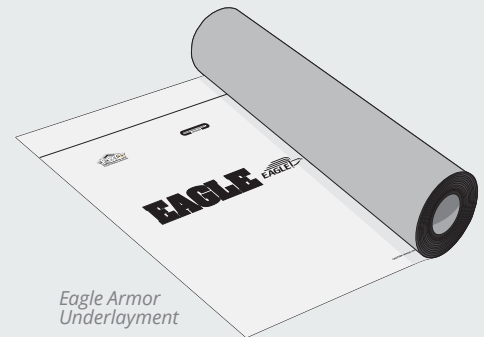

Eagle Armor
Underlayment

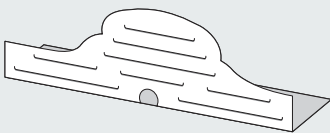

Capistrano Ventilated Birdstop

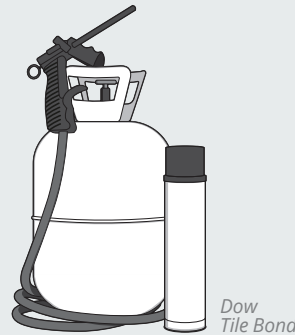

Dow
Tile Bond

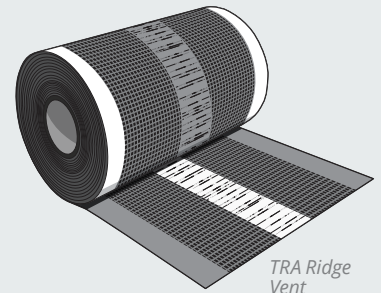

TRA Ridge
Vent

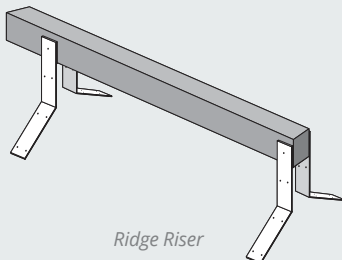

Ridge Riser

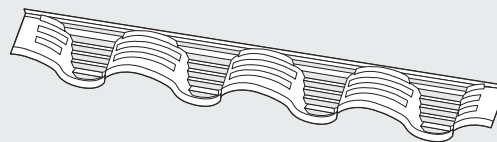

Verde Weatherblock

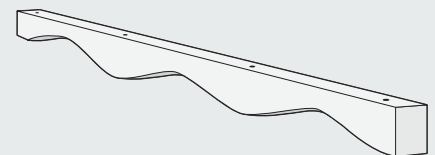

Arched Battens

West Coast Contractor Guide
California, Intermountain, Southwest,
Great Plains, Northwest and Western Canada

USA Owned. USA Made.



O'HAGIN VENT

RIDGE

VALLEY

PIPE FLASHING

COURSE

SIDEWALL

HEADWALL

EAVE



One Roof. One Time.

Providing Trustworthy Solutions for the Building Industry

Since 1989, Eagle Roofing Products has been the trusted leader in the building and roofing industries, offering the largest selection of stunning and sustainable concrete roof tiles in an array of profiles, textures and colors. ***However, we are more than just roof tile.*** We understand that for a functional roof to last decades, it goes beyond just the type of roofing material used. It's about the quality of the components that make up that roof, from the battens to the flashing, ventilation, weather blocking and more.

That's why we have partnered with some of the most established manufacturers in the roofing business to provide our customers with the right roof components to build a strong, reliable roof system that will properly protect their residential or commercial project. ***A dynamic and complete tile roof system that is second to none and one that you can trust.***

Eagle Partners:



Most products contained in this brochure are from third party vendors. **EAGLE ROOFING PRODUCTS DOES NOT WARRANT THESE PRODUCTS.** Please check manufacturer's website for warranty and product information.

Underlayments/Flexible Flashing

SECURE ROLL™ FLEXIBLE FLASHING



**SECURE TILE ROOF™
COMPONENTS**
by Eagle Roofing Products

A flexible flashing material that can be used to make transition areas of a roof watertight. Available in two sizes, Secure Roll has applications for details such as sidewalls, headwalls, chimneys, skylights, pitch changes and roof penetrations.

- USA Made 
- Profile Specific
- Fully Adhered
- Non-Toxic Lead Alternative
- Ideal for Headwalls, Side Walls, Chimneys, Solar and Skylights

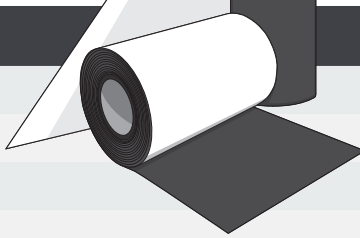
Packaged 2 Per Box				Stock Number
Black Flexible Flashing	11" x 33'	2 per Box		8106
Black Flexible Flashing	11" x 33'	BULK 21 box minimum		8106
Black Flexible Flashing	20" x 16-½'	2 per Box		8108
Black Flexible Flashing	20" x 16-½'	BULK 21 box minimum		8108

Flex Flash

A flexible flashing material that can be used to make transition areas of a roof watertight. Flex Flash has applications for details such as sidewalls, headwalls, chimneys, skylights, pitch changes and roof penetrations.

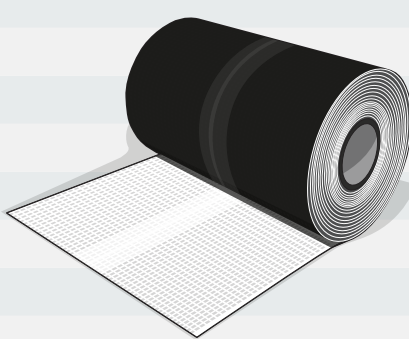

- USA Made 
- Profile Specific
- Easily Conforms To All Profiles
- Easy To Install

Headwall Flashing - 15 ft. Per Roll					Stock Number
Flex Flash - Flat	9"	Terracotta	Aluminum		8127
Flex Flash - Flat	9"	Black	Aluminum		8128
Flex Flash - Malibu	13"	Terracotta	Aluminum		8129
Flex Flash - Malibu	13"	Black	Aluminum		8130
Flex Flash - Capistrano	15-3/4"	Terracotta	Aluminum		8153
Flex Flash - Capistrano	15-3/4"	Black	Aluminum		8154
Flex Flash - Capistrano	17-3/4"	Terracotta	Aluminum		8117
Flex Flash - Capistrano	17-3/4"	Black	Aluminum		8118

Flexible Flashing Installation Tool—Sold Individually

Silicone Rollers



Stock Number

8202

For pricing and availability, please contact your local Eagle Account Representative by visiting: www.eagleroofing.com

If you are in a WUI area, consult with your local jurisdiction.

Flexible Flashing

Flex Seal

A weatherblocking product that can also be used as a flexible transition flashing.

- Butyl Adhesive Weatherblock
- All Aluminum Construction
- Easily Conforms To All Tile Profiles



Non-Vented Hip & Ridge Seal - 25ft. Per Roll				Stock Number
Flex Seal - Flat	9"	Terracotta	Aluminum	8119
Flex Seal - Flat	9"	Black	Aluminum	8120
Flex Seal - Flat	9"	Brown	Aluminum	8133
Flex Seal - Malibu	13"	Terracotta	Aluminum	8123
Flex Seal - Malibu	13"	Black	Aluminum	8124
Flex Seal - Malibu	13"	Brown	Aluminum	8132
Flex Seal - Capistrano	15-3/4"	Terracotta	Aluminum	8125
Flex Seal - Capistrano	15-3/4"	Black	Aluminum	8126

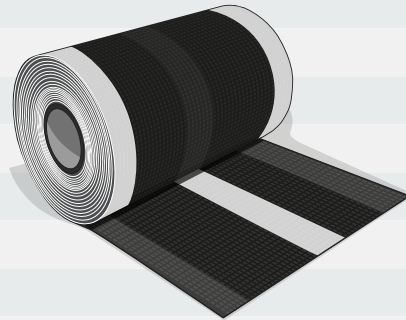

Flex Vent

***Core Ventilated Roof System Component**

A combination weatherblocking/ridge vent. It meets the code requirements to weather block the ridges. It also has vent openings that allow it to be installed for the purposes of attic venting or as part of the Ventilated Roof System. Once installed, it is hidden under the trim tiles.

- Butyl Adhesive Attachment
- All Aluminum Construction
- Easily Conforms To All Tile Profiles
- Enables Attic Venting Through Ridge



Ridge Vent - 25ft. Per Roll				Stock Number
Flex Vent - Flat	9"	Terracotta	Aluminum	8109
Flex Vent - Flat	9"	Black	Aluminum	8110
Flex Vent - Flat	9"	Brown	Aluminum	8134
Flex Vent - Malibu	13"	Terracotta	Aluminum	8113
Flex Vent - Malibu	13"	Black	Aluminum	8114
Flex Vent - Malibu	13"	Brown	Aluminum	8131
Flex Vent - Capistrano	15-3/4"	Terracotta	Aluminum	8115
Flex Vent - Capistrano	15-3/4"	Black	Aluminum	8116

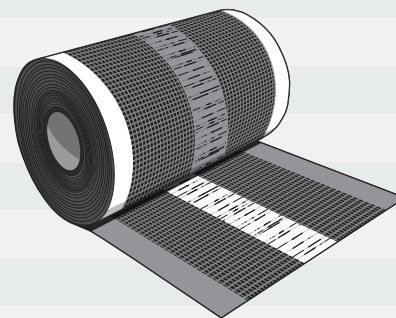

For pricing and availability, please contact your local Eagle Account Representative by visiting: www.eagleroofing.com

If you are in a WUI area, consult with your local jurisdiction.

Underlayment/Arched Battens

Underlayment

Eagle Armor by APOC is a premium, all-purpose fleece top underlayment and leak barrier that pairs beautifully with residential and commercial concrete roof tile applications. Superior protection against wind driven rain, ice dams, leaks and water damage, Eagle Armor by APOC is a high-caliber product that will prolong the life of your roof.

- USA Made 
- Easy To Install
- Helps Prevents Leaks
- Prolongs Life of Roof

APPROVALS:

- Exceeds performance requirements of ASTM D1970, TAS 103 & ICC AC 48.
- Miami-Dade County Product Control Approved.
- ASTM E108 and UL 790 when tested under Eagle Roofing Tiles it becomes a Class A Assembly.
- UL Classified File #R39178.

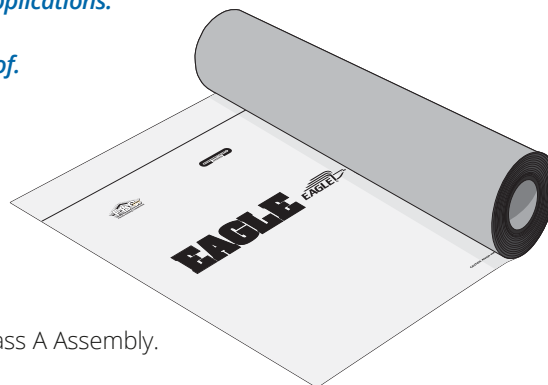

Sold Individually			Stock Number
Eagle Armor	60mils	2 Sq/Roll	8157

ARCHED BATTENS™

ENERGY SAVING. INNOVATIVE DESIGN. SYSTEM DRIVEN.

Made specifically by Eagle, Arched Battens are raised battens that provide attachment for roof tiles with anchor lugs, and promotes airflow under a tile roof. Raising the tiles creates more airspace and aids in insulating the roof in hot climates, prevents ice damming in colder regions and dries out the tile in humid areas.

- USA Made 
- Created From Graded Lumber
- Prevents Water Damming
- Provides Thermal Barrier and Ventilation



**SECURE TILE ROOF™
COMPONENTS**

by Eagle Roofing Products



***Core Ventilated Roof System Component**

1 Square Per Bundle		Stock Number
Arched Battens - 1" x 1-3/16" x 8'	12/100 sq. ft.	8628
Borax Treated Arched Battens - 1" x 1-3/16" x 8'	12/100 sq. ft.	8629
Arched Battens - 1" x 1-3/16" x 4'	24/100 sq. ft.	8630
Borax Treated Arched Battens - 1" x 1-3/16" x 4'	24/100 sq. ft.	8631

Available Truck Loading	Bundle Quantities
Arched Battens 1" x 1-3/16" x 4'	100-450 Bundles, 451-1200 Bundles, 1201-2400 Bundles
Arched Battens 1" x 1-3/16" x 8'	100-450 Bundles, 451-900 Bundles, 901-1800 Bundles
Borax Treated Arched Battens 1" x 1-3/16" x 4'	100-450 Bundles, 451-1200 Bundles, 1210-2400 Bundles
Borax Treated Arched Battens 1" x 1-3/16" x 8'	100-450 Bundles, 451-900 Bundles, 901-1800 Bundles

All Bulk orders must be shipped within (5) business days of the first shipment.

For pricing and availability, please contact your local Eagle Account Representative by visiting: www.eagleroofing.com

If you are in a WUI area, consult with your local jurisdiction.

Ventilation

O'Hagin Tile Roof Vents

***Core Ventilated Roof System Component**



O'Hagin Vents are off-ridge vents that can be installed for the purposes of attic venting or as part of the Ventilated Roof System. O'Hagin Vents are designed as a two-piece system consisting of a primary vent (subflashing) and a profile-specific secondary vent (cover) which blends into the surrounding field tile.

- USA Made 
- Profile Specific
- May Be Utilized For Air Intake and Exhaust
- Provide Superior Airflow
- Easy To Install

Sold Individually					Number
O'Hagin Roof Vent - Malibu	26" x 19", 4" Flange	9 lbs	Galvanized		8210
O'Hagin Roof Vent - Capistrano	24" x 19", 4" Flange	8 lbs	Galvanized		8211
O'Hagin Roof Vent - Flat	29" x 19", 4" Flange	10 lbs	Galvanized		8212
O'Hagin Fire-Ice Vent Malibu	26" x 19", 4" Flange	10 lbs	Galvanized with stainless-steel mesh		8213
O'Hagin Fire-Ice Vent Capistrano	24" x 19", 4" Flange	9 lbs	Galvanized with stainless-steel mesh		8214
O'Hagin Fire-Ice Vent Flat	29" x 19", 4" Flange	11 lbs	Galvanized with stainless-steel mesh		8215

O'Hagin Flat

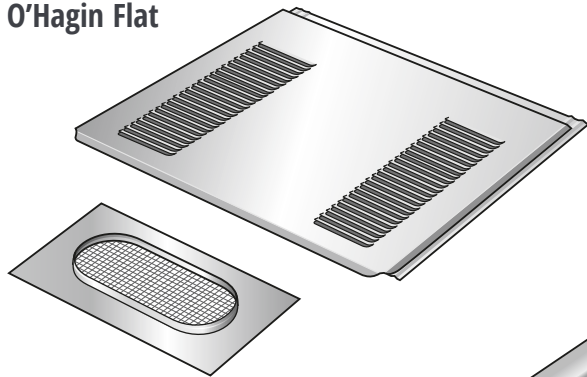

O'Hagin Malibu

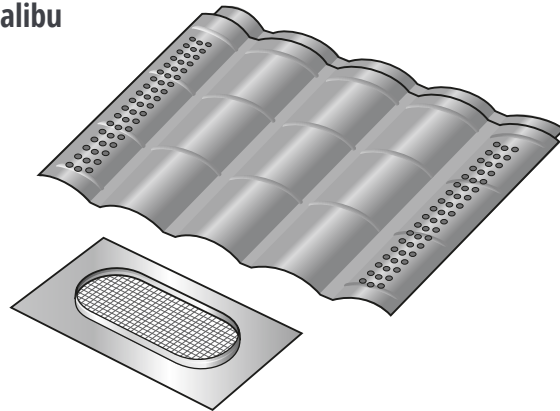

O'Hagin Capistrano

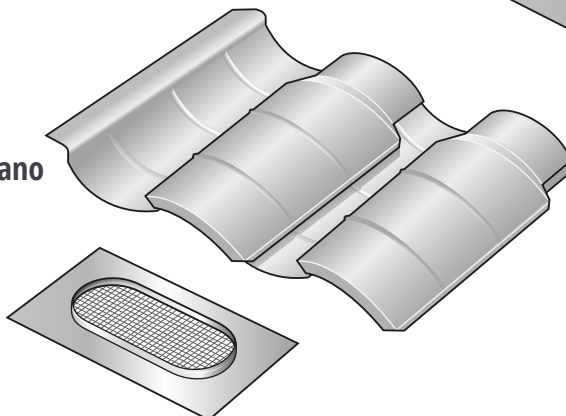

For pricing and availability, please contact your local Eagle Account Representative by visiting: www.eagleroofing.com

If you are in a WUI area, consult with your local jurisdiction.

Weather Blocking

Verde Weatherblock

Verde Weatherblock is a rigid, UV-stable plastic weatherblocking product that is profile specific. Attached to the trim nailer board prior to the attachment of the trim, it is available in straight ridge pieces and angled hip pieces. (For flat tile, a universal piece is used.)



- USA Made 
- Available For All Profiles
- Alternative To Mortar
- Ideal For All Climates
- U.V. Resistant

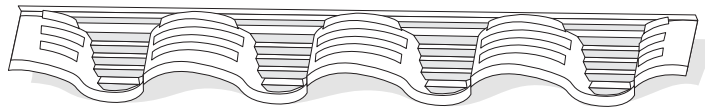

Sold in Footage				Stock Number
Universal Flat - Hip/Ridge	200' per box	Plastic		8218
Malibu - Ridge	300' per box	Plastic		8219
Malibu - Left Hip, Right Hip	300' per box	Plastic		8220
Capistrano - Ridge	300' per box	Plastic		8221
Capistrano - Left Hip, Right Hip	300' per box	Plastic		8222

RAKE SEAL™

ARCHITECTURALLY DRIVEN
RAKE DETAIL ENHANCEMENT



**SECURE TILE ROOF™
COMPONENTS**
by Eagle Roofing Products

Rake Seal is a weatherblocking material that takes the place of rake tile or mortar on rake edges. Rake Seal is designed for flat tile roofs, and is available in two sizes for roofs with and without battens.

- USA Made 
- Gable End Finish
- Nailable/Adhesive
- U.V. Resistant
- Alternative to Rake Trim

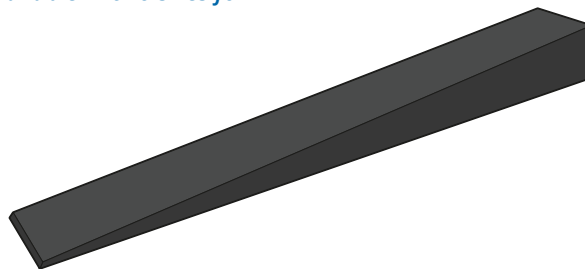

Approx. 100 Per Box			Stock Number
Flexible Foam	Direct to Deck		8507
Flexible Foam	Raised/Batten		8508

Weatherblock

Approx. 10 Ft. Per Piece			Stock Number
Capistrano	Black	Galvanized	7012 E
Capistrano	Terracotta	Galvanized	7013 E

For pricing and availability, please contact your local Eagle Account Representative by visiting: www.eagleroofing.com

If you are in a WUI area, consult with your local jurisdiction.

Weather Blocking, Installation Details

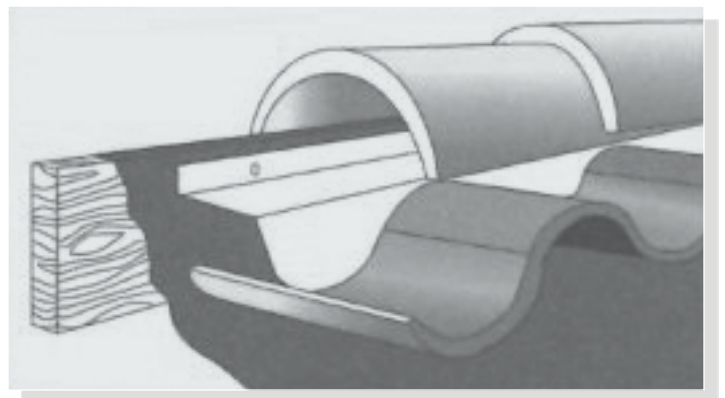
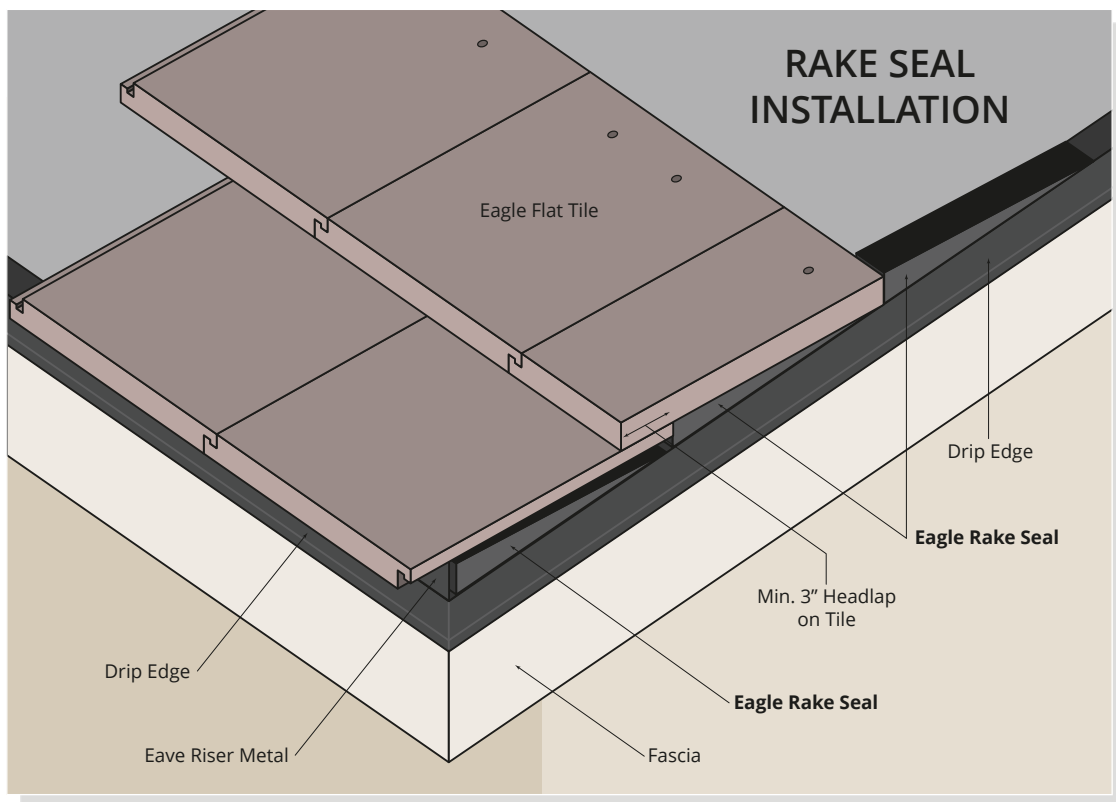
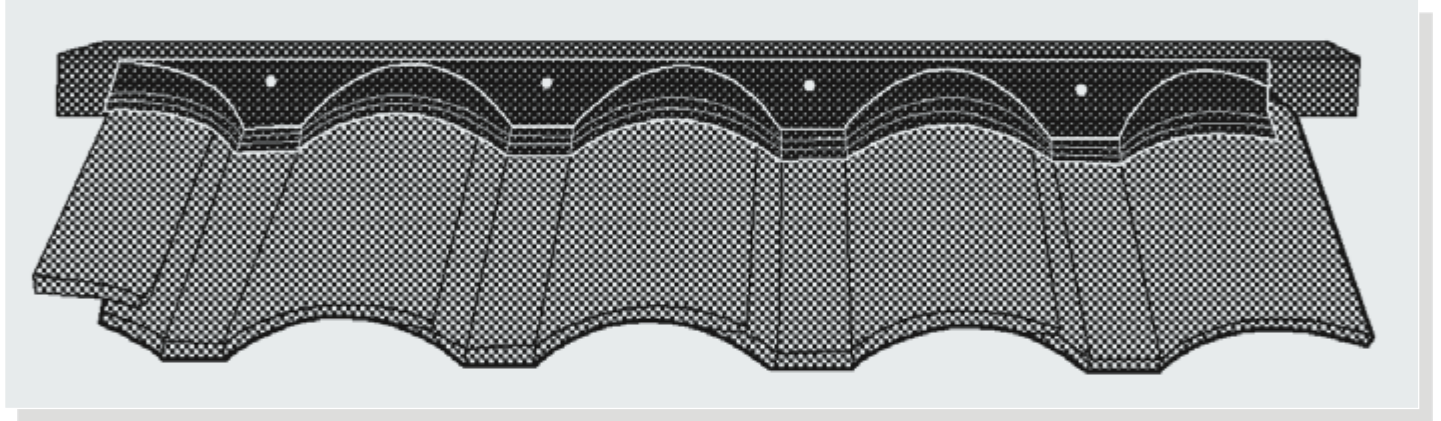

Metal Flashing

Metal Flashings

***Core Ventilated Roof System Component**

- USA Made 
- Profile Specific
- Large Nailing Flange

Approximately 10ft. Per Piece—26 Gauge				Stock Number
Capistrano Birdstop		Terracotta	Galvanized	7000 E
Capistrano Birdstop		Black	Galvanized	7010 E
Capistrano Ventilated Birdstop*		Terracotta	Galvanized	7500
Capistrano Ventilated Birdstop*		Black	Galvanized	7510
Capistrano Raised Ventilated Birdstop*		Terracotta	Galvanized	7501
Capistrano Raised Ventilated Birdstop*		Black	Galvanized	7511
Capistrano Raised Non-Vented Birdstop		Terracotta	Galvanized	7522
Capistrano Raised Non-Vented Birdstop		Black	Galvanized	7518
Malibu Birdstop		Terracotta	Galvanized	7020 E
Malibu Birdstop		Black	Galvanized	7030 E
Malibu Ventilated Birdstop*		Terracotta	Galvanized	7520
Malibu Ventilated Birdstop*		Black	Galvanized	7530
Malibu Raised Ventilated Birdstop*		Terracotta	Galvanized	7521
Malibu Raised Ventilated Birdstop*		Black	Galvanized	7531
Malibu Raised Non-Vented Birdstop		Terracotta	Galvanized	7523
Malibu Raised Non-Vented Birdstop		Black	Galvanized	7525
Flat Eave Riser	1-1/2" x 1-1/2"	Black	Galvanized	7080 E
Flat Eave Riser	1-1/2" x 1-1/2"	Brown	Galvanized	7060 E
Flat Ventilated Eave Riser*	1-1/2" x 1-1/2"	Brown	Galvanized	7560
Flat Ventilated Eave Riser*	1-1/2" x 1-1/2"	Black	Galvanized	7590
Flat Raised Ventilated Eave Riser*	2" x 2"	Black	Galvanized	7591
Flat Raised Ventilated Eave Riser*	2' x 2"	Brown	Galvanized	7561
Flat Raised Non-Vented Eave Riser	2" x 2"	Black	Galvanized	7519
Flat Raised Non-Vented Eave Riser	2" x 2"	Brown	Galvanized	7524
Raised Rake	OA: 5.5" x 3", Ribbed Pan: 4", Raised Face: 3", Fascia Cover: 1.5"	Black	Galvanized	7087 E
Raised Rake	OA: 5.5" x 3", Ribbed Pan: 4", Raised Face: 3", Fascia Cover: 1.5"	Brown	Galvanized	7086 E
Standard Rake	OA: 4" x 5", Ribbed Pan: 4", Raised Face: 3", Drip Edge: 2"	Black	Galvanized	7092 E
Standard Rake	OA: 4" x 5", Ribbed Pan: 4", Raised Face: 3", Drip Edge: 2"	Brown	Galvanized	7089 E

For pricing and availability, please contact your local Eagle Account Representative by visiting: www.eagleroofing.com

If you are in a WUI area, consult with your local jurisdiction.

Metal Flashing, Down Slope Eave Details

Capistrano Birdstop

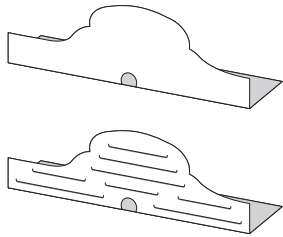

Malibu Birdstop

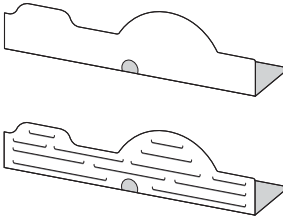

Flat Profiles

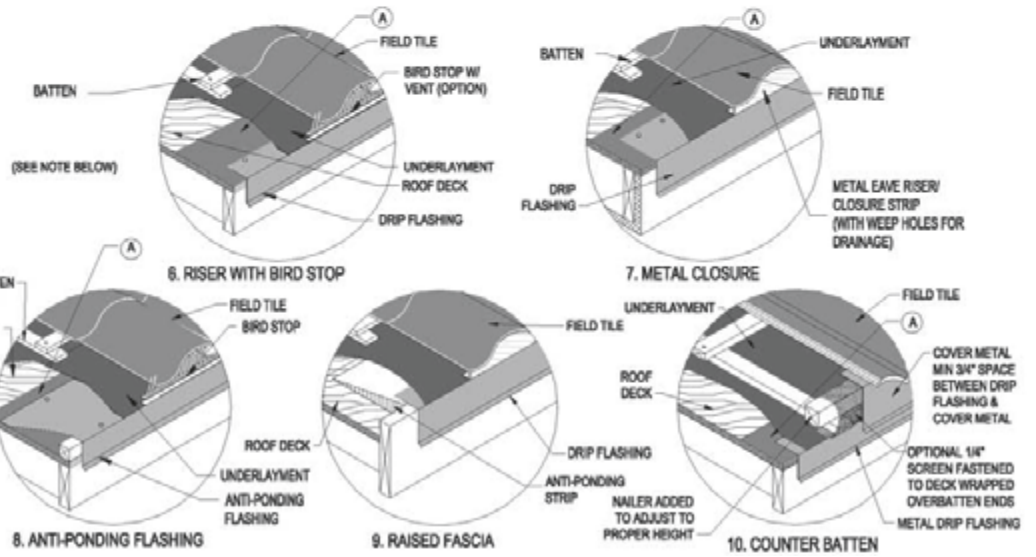
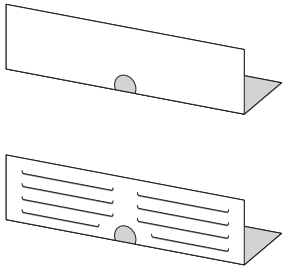

Notes:

1. Bird stop is required on High profile tile and optional on Low and Medium profile tile unless required by local building official.
2. Bird stop may be either solid or vented.
- A. Optional Separator ply or sheet of No.15 asphalt-saturated felt or other appropriate material.

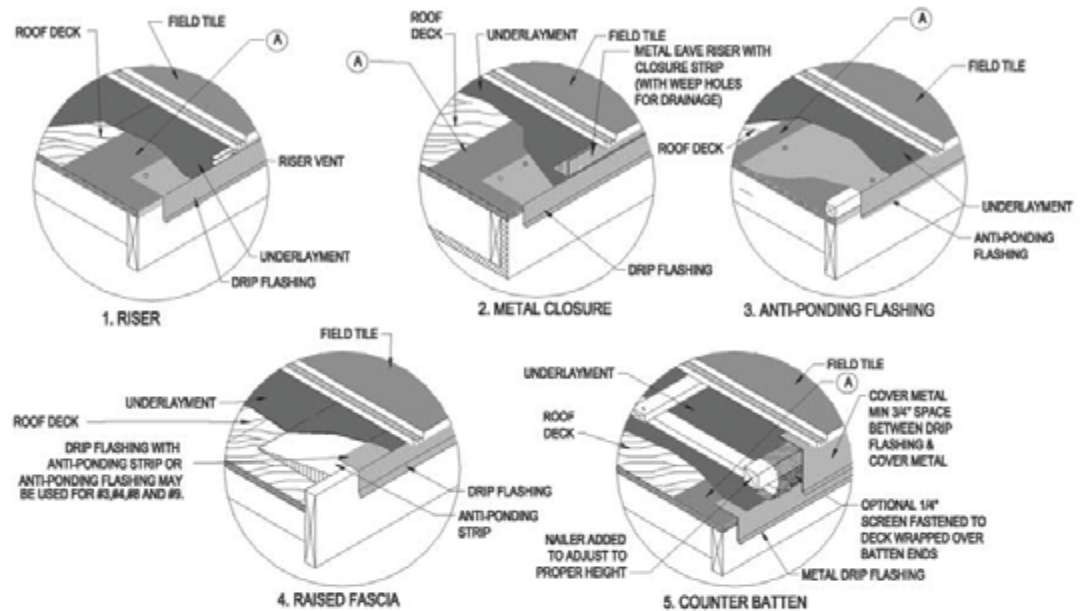

Single Piece Raised Rake

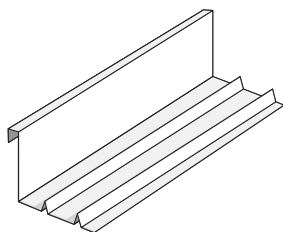

Single Piece Standard Rake

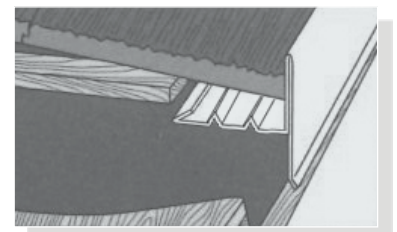
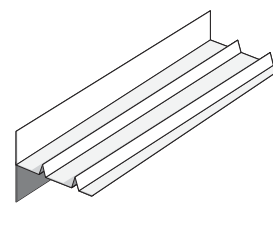

For pricing and availability, please contact your local Eagle Account Representative by visiting: www.eagleroofing.com

If you are in a WUI area, consult with your local jurisdiction.

Brackets, Clips & Fasteners

Ridge Brackets

Sold Individually			Stock Number
Ridge Bracket		Galvanized	8201

Snow Brackets

Sold Individually			Stock Number
"A" Snow Bracket	16-1/16"L x 3-3/8"W x 3"H	Black Steel	11004
"A" Snow Bracket	16-1/16"L x 3-3/8"W x 3"H	Brown Steel	11003

Wind Clips

500 Per Box			Stock Number
Capistrano	3-3/8"	Galvanized	6036
Malibu	2-7/8"	Galvanized	6034
Flat	2-1/4"	Galvanized	6037
Flat-Fascia	3/4"	Galvanized	6033

Boosted Capistrano Wire Clips

Approx. 100 Per Box			Stock Number
Boosted Capistrano Wire Clips		Stainless Steel	6966

Roof Tile Adhesive

Tile Bond is an adhesive foam that is used to attach tiles. Tile Bond can be used in high-wind applications with or without mechanical fasteners. It can also be used for applications where mechanical fasteners are not an option or not preferred.

Tile Bond			Stock Number
23lb. Foam Canister, Hose/Gun, Wrench, Valve	Kit	One	8140
28 oz. Repair Cans	Case	12 Cans	8141

Brackets, Clips & Fastener, Installation Details

Ridge Brackets

***Core Ventilated Roof System Component**

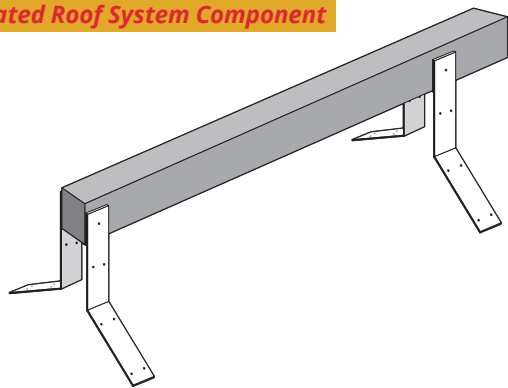

Snow Bracket

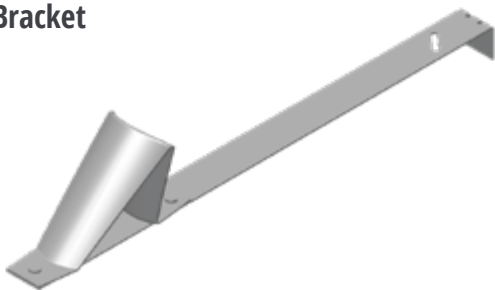

Capistrano Wind Clip

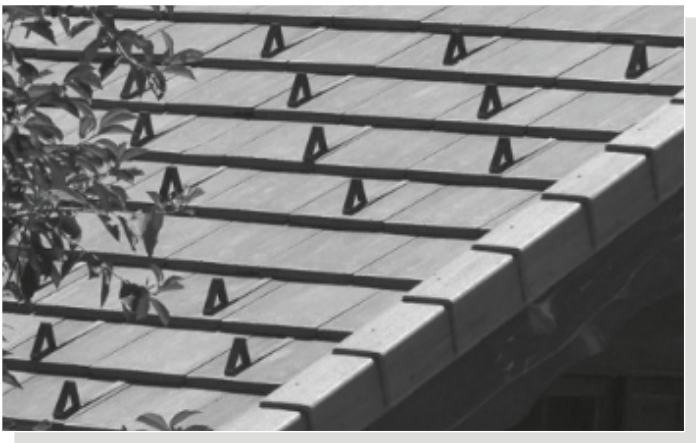
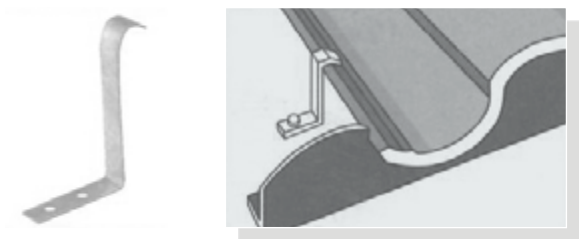

Malibu Wind Clip

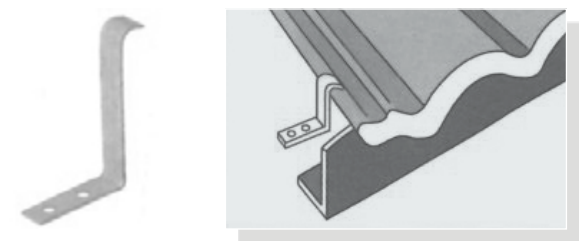

Boosted Capistrano Wire Clips

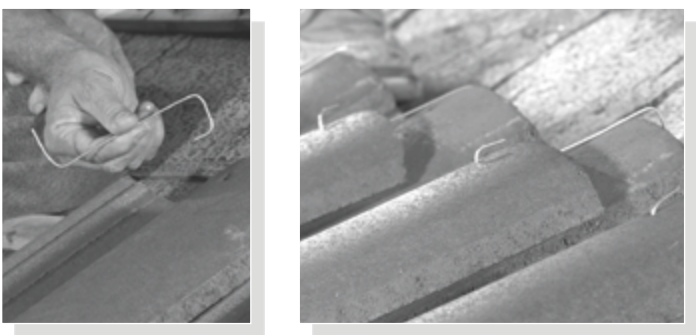

Flat Wind Clip



Roof Tile Adhesive



Flat Fascia Wind Clip

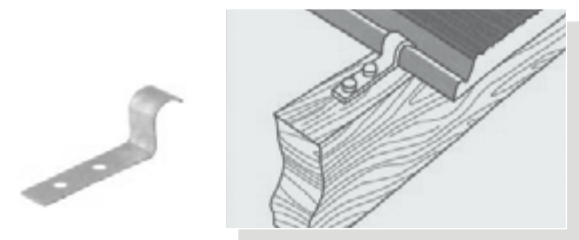



3 EXHAUST

2 AIRFLOW

1 INTAKE



The Ventilated Roof System: Function and Beauty At Its Finest

There is no doubt that an Eagle concrete tile roof is beautiful and incredibly durable. However, did you know that you can increase the longevity of the roof itself, and further enhance the inherent energy efficiency properties and R-value, by upgrading to a Ventilated Roof System?

A Ventilated Roof System is comprised of three key elements and components:

1. Intake: Air enters the roof system through a **perforated metal eave closure**.

A standard eave closure offers a small drainage opening and does not encourage air intake.

2. Airflow: The velocity of the airflow under the roof tiles is elevated by using **Eagle's Arched Battens**. The arches serve a dual purpose of promoting energy saving airflow, while facilitating drainage preventing water damage to the underlayment and roof deck.

3. Exhaust: Proper air exhaust occurs in the upper third of the tile roof system. Exhaust can be accomplished with ridge ventilation, or with profile specific **O'Hagin Roof Vents**.

Install a concrete tile roof you can be proud of! The Ventilated Roof System aids in extending the lifespan of the underlayment, and components, as well as helps your customers save on energy costs by reducing the heat transfer through the attic into the living space.

For more information on the Ventilated Roof System and accompanying components, please contact your local Eagle Account Representative at www.eagleroofing.com

Eagle Design Centers & Manufacturing Facilities Servicing the United States and Canada

Whether you are an Architect, Builder, Designer, Distributor, Roofer or Homeowner, with four manufacturing plants servicing the United States and Canada, our customers can rest assured that we can provide the highest quality roofing materials and components to meet their needs. Durable, sustainable products and lasting customer relationships are the core of our business. That's what inspires us to be your company of choice. **That's what makes us different.**



Eagle Design Centers

Southern California

Irvine
17875 Sky Park Circle, Suite F
Irvine, CA 92614
Phone: 949-553-8333

Rialto
2352 N. Locust Ave., Gate 2
Rialto, CA 92377
Phone: 800-400-3245

Arizona

Phoenix
4608 W. Elwood
Phoenix, AZ 85043
Phone: 602-346-1749

Northern California

Granite Bay
7095 Douglas Blvd., Ste. K
Granite Bay, CA 95746
Phone: 916-789-4555

Florida

Orlando Area
402 Northlake Blvd., Suite 1028
Altamonte Springs, FL 32701
Phone: 407-691-7100

Manufacturing & Stocking Yards

Southern California

Rialto
2352 N. Locust Ave., Gate 1
Rialto, CA 92377
Phone: 1-800-300-3245

Florida/East Coast

Central Florida
1575 E. CR 470
Sumterville, FL 33585
Phone: 1-877-300-3245

Southwest

Phoenix
4602 W. Elwood
Phoenix, AZ 85043
Phone: 1-800-346-5260

Northern California

Stockton
4555 South McKinley Ave.
Stockton, CA 95206
Phone: 1-800-998-3245

Southern Florida
1801 SW 42nd Way
Deerfield Beach, FL 33442
Phone: 1-877-300-3245



Corporate Offices

3546 N. Riverside Ave.
Rialto, CA 92377
Phone: 909-822-6000
www.eagleroofing.com

Eagle is proud to be affiliated with these organizations:



Connect with us!

